



# PRICE LIST

w.e.f 15 APRIL 2026

The Power<sup>®</sup>  
of Power



## SWITCH GEARS



- PROTECTION
- LIGHTING

- DISTRIBUTION
- MEASURING

E  
X  
C  
E  
L  
L  
E  
N  
C  
E

SINCE 1968



s-escoelectricals.com



Info@s-escoelectricals.com



escoswitchgears@gmail.com

An  
ISO 9001:2015  
Certified company



### **Profile:-**

Established in the Year 1968, at New Delhi, India, we Electrical Sales Corporation are committed to provide stability and strength to varied electrical installation around the nation. With brand name ESCO Switchgears, we are manufacturing and supplying a qualitative range of Electrical Products such as M.C.B's R.C.C.B's & isolators Changeovers, etc. This entire array is fabricated at our well-equipped production unit under the supervision of our highly qualified engineers making use of modern machinery cutting edge technology and high grade components. Owing to dimensional accuracy, elevated durability, fire resistance and high strength our offered products have gained huge demand across varied industrial, residential and commercial sector, In our product gamut we are offering M.C.B. Distribution Boards Industrial Box, Plug & Socket Re-wirable Switch fuse Units, Fuse Switch Units Changeovers, Bus Bars Chambers Fuse Units (Kit Kat) Panel accessories, Cable Ducting Solution etc.

### **Product**

1. INDEX
2. MCB SELECTION CHART
3. MCB & ISOLATORS
4. RCCB & MCB Change Over
5. MCB Enclosure's & ECO S/DOOR MCB DB
6. MCB DB Trans Lit, Ex Class , TITAN & Vertical
7. MCCB & MCCB Enclosure's
8. Industrial Plug Socket & Box
9. PHASE SELECTOR BOARD
10. S.D.F.U
11. Rewirable & HRC Switches
12. Fuse Units (KitKat)
13. H.R.C FUSE & BASE
14. On Load Panel Change Over
15. Automatic & OFF Load change Over
16. L.T. Control & Spares
17. Bus Bar Chamber
18. Compatible Bus Bar Chamber

### Switch Fuse Unit (SFU/FSU/SDF)

The Rewirable Switch Fuse Units are used for distributing power and protecting electrical devices and cables from damage due to fluctuations. This fuse unit is housed in an enclosure made using quality CR steel sheet.

### (MCB/MCCB)

A circuit breaker is an automatically operated electrical switch designed to protect an electrical circuit from damage caused by excess current from an overload or short circuit. Its basic function is to interrupt current flow after a fault is detected.

### For Main incomer like MCB/MCCB/SFU selection:

First Calculate total connected load using individual equipment wattage as given above, then find out total load current using given formula.

this load current gives main incomer rating.

#### Note:

1. While calculation you should consider diversity factor and power factor of Loads.
2. Add 10% extra for future expansion depending upon the situation.

### (Indicative MCB Selection Chart)

Sr. No.	Items	Load/Wattage	MCB rating	Wire size Sq. mm
01	Fan	60 W	0.5 A	1
02	Lamp, Tubelight	40 W	0.5 A	1
03	Room Heater	200 W	1 A	1.5
04	Water Heater			
	8 ltrs	1200-2000 W	10 A	2.5
	15 ltrs	3000-4000 W	20 A	4
	30 ltrs.	4000-6000 W	32 A	6
05	Immersion Heater	1000 W	6 A	1.5
06	Hot Plate-single	1000 W	6 A	1.5
07	Iron- non automatic	500 W	3 A	1.5
	automatic	1000 W	6 A	1.5
08	Mixer/ Juicer	300 W	2 A	1.5
09	TV/VCR	200 W	1 A	1.5
10	Music system	200 W	1 A	1.5
11	Refrigerator			
	165 ltrs	400 W	3 A	1.5
	285 ltrs	600 W	4 A	1.5
	350 ltrs	750 W	6 A	1.5
12	Toaster	500 W	3 A	1.5
13	Vacuum Cleaner	400 W	3 A	1.5
14	Washing machine			
	without heater	300-1300 W	10 A	2.5
	with heater	5000-6300 W	32 A	6
15	Water Cooler	700 W	6 A	1.5
16	Desert Cooler	300 W	2 A	1.5
17	Oven	750 W	6 A	1.5
18	Electrical Kettle	1500 W	7.5 A	1.5
19	Air Conditioner			
		1 ton	10 A	2.5
		1.5 ton	25	4
		2 ton	32	4
20	Hair Dryer	1000 W	7.5 A	1.5
21	Microwave	800 W	6 A	1.5
Formula for Calculation :				
Incomer Rating :		Single Phase = Total Load in Watts 230 volts		
		Triple Phase = Total Load in Watts 3x230 volts		

## Miniature Circuit Breaker's (M.C.B)

HSN Code 85362030

In Accordance With IS/IEC 60898-1 CM/L- 8460983 'C' SERIES 50 Hz. 230/415 V.

### 1 Pole (S.P)

AMPS.	C. No.	PRICE	PKG.
6 A	SMSP-001	120.00	12/192 Pcs.
10 A	SMSP-002	120.00	12/192 Pcs.
16 A	SMSP-003	120.00	12/192 Pcs.
20 A	SMSP-004	120.00	12/192 Pcs.
25 A	SMSP-005	120.00	12/192 Pcs.
32 A	SMSP-006	120.00	12/192 Pcs.

### 1 Pole With Neutral (S.P.N)

AMPS.	C. No.	PRICE	PKG.
6 A	SMSN-008	230.00	6/96 Pcs.
10 A	SMSN-009	230.00	6/96 Pcs.
16 A	SMSN-010	230.00	6/96 Pcs.
20 A	SMSN-011	230.00	6/96 Pcs.
25 A	SMSN-012	230.00	6/96 Pcs.
32 A	SMSN-013	230.00	6/96 Pcs.

### 2 Pole(D.P)

AMPS.	C. No.	PRICE	PKG.
6 A	SMDP-017	245.00	6/96 Pcs.
10 A	SMDP-018	245.00	6/96 Pcs.
16 A	SMDP-019	245.00	6/96 Pcs.
20 A	SMDP-020	245.00	6/96 Pcs.
25 A	SMDP-021	245.00	6/96 Pcs.
32 A	SMDP-022	245.00	6/96 Pcs.
40 A	SMDP-023	395.00	6/96 Pcs.
63 A	SMDP-024	545.00	6/96 Pcs.

### 3 Pole (T.P)

AMPS.	C. No.	PRICE	PKG.
6 A	SMTP-026	390.00	8/64 Pcs.
10 A	SMTP-027	390.00	8/64 Pcs.
16 A	SMTP-028	390.00	8/64 Pcs.
20 A	SMTP-029	390.00	8/64 Pcs.
25 A	SMTP-030	390.00	8/64 Pcs.
32 A	SMTP-031	390.00	8/64 Pcs.
40 A	SMTP-032	575.00	8/64 Pcs.
63 A	SMTP-033	725.00	8/64 Pcs.

### 3 Pole With Neutral (T.P.N)

AMPS.	C. No.	PRICE	PKG.
6 A	SMTN-035	500.00	6/48 Pcs.
10 A	SMTN-036	500.00	6/48 Pcs.
16 A	SMTN-037	500.00	6/48 Pcs.
20 A	SMTN-038	500.00	6/48 Pcs.
25 A	SMTN-039	500.00	6/48 Pcs.
32 A	SMTN-040	500.00	6/48 Pcs.
40 A	SMTN-041	685.00	6/48 Pcs.
63 A	SMTN-042	835.00	6/48 Pcs.

### 4 Pole(F.P)

AMPS.	C. No.	PRICE	PKG.
6 A	SMFP-044	575.00	6/48 Pcs.
10 A	SMFP-045	575.00	6/48 Pcs.
16 A	SMFP-046	575.00	6/48 Pcs.
20 A	SMFP-047	575.00	6/48 Pcs.
25 A	SMFP-048	575.00	6/48 Pcs.
32 A	SMFP-049	575.00	6/48 Pcs.
40 A	SMFP-050	725.00	6/48 Pcs.
63 A	SMFP-051	935.00	6/48 Pcs.

## Isolators 50 Hz. 240/415 V

HSN Code 85362030

### 2 Pole(D.P)

AMPS.	C. No.	PRICE	PKG.
40 A	SMID-053	215.00	6/96 Pcs.
63 A	SMID-054	260.00	6/96 Pcs.
100 A	SMID-055	435.00	6/96 Pcs.

### 3 Pole(T.P)

AMPS.	C. No.	PRICE	PKG.
40 A	SMIT-056	325.00	6/48 Pcs.
63 A	SMIT-057	385.00	6/48 Pcs.
100 A	SMIT-058	665.00	6/48 Pcs.

### 4 Pole(F.P)

AMPS.	C. No.	PRICE	PKG.
40 A	SMIF-059	450.00	6/48 Pcs.
63 A	SMIF-060	550.00	6/48 Pcs.
100 A	SMIF-062	950.00	6/48 Pcs.

**RCCB's (ELCB)** Protection Against Earth Leakage 10kA , 50 Hz. 240/415 V.

HSN Code 85362040

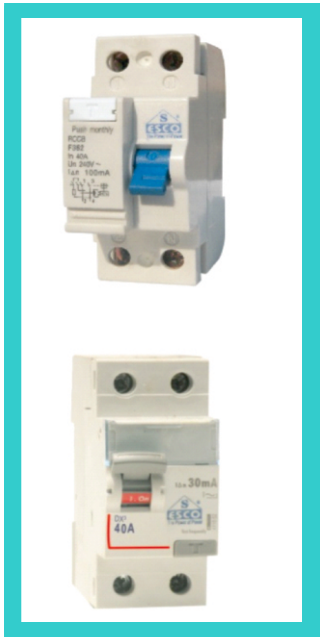

**Eco**

2 Pole (D.P) 30 Ma / 100 mA / 300 mA

AMPS.	C. No.	PRICE	PKG.
25 A	SRDP-083	1385.00	6/96 Pcs.
32 A	SRDP-084	1520.00	6/96 Pcs.
40 A	SRDP-085	1700.00	6/96 Pcs.
63 A	SRDP-086	1970.00	6/96 Pcs.

4 Pole (F.P) 30 Ma / 100 mA / 300 mA

AMPS.	C. No.	PRICE	PKG.
25 A	SRFP-086	1835.00	6/48 Pcs.
32 A	SRFP-087	2024.00	6/48 Pcs.
40 A	SRFP-089	2150.00	6/48 Pcs.
63 A	SRFP-090	2375.00	6/48 Pcs.

**Gaurdian**

2 Pole (D.P) 30 Ma / 100 mA / 300 mA

AMPS.	C. No.	PRICE	PKG.
25 A	SRG2P-0026	1835.00	6/96 Pcs.
40 A	SRG2P-0044	1970.00	6/96 Pcs.
63 A	SRG2P-0062	2150.00	6/96 Pcs.

4 Pole (F.P) 30 Ma / 100 mA / 300 mA

AMPS.	C. No.	PRICE	PKG.
25 A	SRG4P-071	2960.00	6/48 Pcs.
40 A	SRG4P-080	3230.00	6/48 Pcs.
63 A	SRG4P-098	3635.00	6/48 Pcs.

**Mini MCB's & Isolators** 3kA , 50 Hz. 240 V.

HSN Code 85362030



**Modular Sr.**

M.C.B 1 Pole (S.P)

AMPS.	C. No.	PRICE	PKG.
6 A	SMMSp-063	161.00	10/200 Pcs.
10 A	SMMSp-064	161.00	10/200 Pcs.
16 A	SMMSp-065	161.00	10/200 Pcs.
20 A	SMMSp-066	161.00	10/200 Pcs.
25 A	SMMSp-067	161.00	10/200 Pcs.
32 A	SMMSp-068	161.00	10/200 Pcs.
40 A	SMMSp-069	278.00	10/200 Pcs.

M.C.B 2 Pole (D.P)

AMPS.	C. No.	PRICE	PKG.
6 A	SMMDP-069	305.00	5/100 Pcs.
10 A	SMMDP-070	305.00	5/100 Pcs.
16 A	SMMDP-071	305.00	5/100 Pcs.
20 A	SMMDP-072	305.00	5/100 Pcs.
25 A	SMMDP-073	305.00	5/100 Pcs.
32 A	SMMDP-074	305.00	5/100 Pcs.
40 A	SMMDP-075	440.00	5/100 Pcs.

MINI ISOLATOR 2 Pole (D.P)

40 A	SMID-070	242.00	5/100 Pcs.
------	----------	--------	------------

**Change Over** Center off 2way 50 Hz. 240/415 V.

HSN Code 85365010



2 Pole (D.P)

AMPS.	C. No.	PRICE	PKG.
25 A	SMCO-076	395.00	6/96 Pcs.
32 A	SMCO-077	422.00	6/96 Pcs.
40 A	SMCO-078	458.00	6/96 Pcs.
63 A	SMCO-062	557.00	6/96 Pcs.

4 Pole (F.P)

AMPS.	C. No.	PRICE	PKG.
25 A	SMCO-080	755.00	6/48 Pcs.
32 A	SMCO-081	845.00	6/48 Pcs.
40 A	SMCO-082	890.00	6/48 Pcs.
63 A	SMCO-089	1115.00	6/48 Pcs.

## M.C.B DB BLANK PLATE

HSN Code 8538000



PRICE	PKG.
5.00	100/1000 Pcs.

## M.C.B Enclosure's (I.P 20 Protetion)



### P.C GREEN

HSN Code 85381090

Poles	C.No	PRICE	PKG
1/2 P	SPCG-001	42.00	20/240 Pcs
3/4 P	SPCG-003	62.00	10/190 Pcs



### P.C TRANS DOOR

Poles	C.No	PRICE	PKG
1/2 P	SPAD-001	80.00	12/144 Pcs
3/4 P	SPAD-003	120.00	8/96 Pcs

HSN Code 85381090



### M.S With Sheet Metal Cover

Poles	C. No.	PRICE	PKG.
1/2 P	SSDB-021	194.00	60 Pcs.
3/4 P	SSDB-022	260.00	40 Pcs.

## M.C.B Distribution Boards (I.P 20 Protetion)

HSN Code 85372000



### Eco

Sheet Steel, fitted with Bus Bar, Neutal Links , Earth Bar , Din Channell & Blank Plate.

#### S.P.N

Ways	C. No.	PRICE	PKG.
4 W	SSDB-023	433.00	30Pcs.
6 W	SSDB-024	510.00	30Pcs.
8 W	SSDB-017	630.00	24Pcs.
10 W	SSDB-026	770.00	20Pcs.
12 W	SSDB-027	890.00	16Pcs.
16W	SSDB-028	1140.00	12Pcs.

#### T.P.N

Ways	C. No.	PRICE	PKG.
4W	TSDB-047	1860.00	5Pcs.
6W	TSDB-048	2430.00	5Pcs.
8W	TSDB-049	3150.00	4Pcs.
12W	TSDB-050	4500.00	3Pcs.

## Trans Lit - S.P.N

HSN Code 85372000

Push Open See Through Acrylic Cover With Sheet Steel Base Fitted With Bus Bar, Neutral Links , Earth Bar , Din Channel & Dummy Plate.



WHITE			
Ways	C. No.	PRICE	
4 W	STLDB-008	680.00	
6 W	STLDB-017	890.00	
8 W	STLDB-026	1140.00	
12 W	STLDB-035	1680.00	
16 W	STLDB-044	2420.00	

DECOR		
C. No.	PRICE	PKG
SPTL-50	710.00	36 Pcs.
SPTL-51	930.00	20 Pcs.
SPTL-52	1200.00	16 Pcs.
SPTL-53	1740.00	12 Pcs.
SPTL-54	2490.00	8 Pcs.



## Elegant - Ex Class

HSN Code 85372000

Sheet Steel, fitted with Bus Bar, Neutral Links , Earth Bar , Din Channel & Dummy Plate.



### S.P.N

Ways	C. No.	PRICE	PKG.
4 W	SEDB-035	860.00	14 Pcs.
6 W	SEDB-036	990.00	12 Pcs.
8 W	SEDB-037	1170.00	12 Pcs.
10W	SEDB-038	1400.00	10 Pcs.
12W	SEDB-039	1650.00	8 Pcs.
16W	SEDB-040	2100.00	6 Pcs.

### T.P.N

Ways	C. No.	PRICE	PKG.
4 W	TEDB-055	2550.00	5 Pcs.
6 W	TEDB-056	3200.00	3 Pcs.
8 W	TEDB-057	4050.00	2 Pcs.
12W	TEDB-058	5790.00	1Pcs

### TITAN

#### S.P.N

Ways	C.No.	PRICE	PKG
4 W	STDB-50	990.00	20 Pcs
6 W	STDB-51	1140.00	16 Pcs
8 W	STDB-55	1400.00	16 Pcs
10 W	STDB-60	1590.00	12 Pcs
12 W	STDB-64	1800.00	10 Pcs
16 W	STDB-66	2350.00	8 Pcs

#### T.P.N

Ways	C.No.	PRICE	PKG
4 W	TTDB-68	2800.00	6 Pcs
6 W	TTDB-69	3480.00	4 Pcs
8 W	TTDB-71	4350.00	3 Pcs
12 W	TTDB-72	6200.00	1 Pcs

## Vertical

HSN Code 85372000

Sheet Steel, fitted with Bus Bar, Neutral Links , Earth Bar , Din Channel & Dummy Plate.

### Incoming: Isolator

Ways	C. No.	PRICE	PKG.
4 W	TVIDB-062	6480.00	2 Pcs.
8 W	TVIDB-063	8200.00	1 Pcs.
12 W	TVIDB-064	15000.00	1 Pcs.

### Incoming: MCCB

Ways	C. No.	PRICE	PKG.
4 W	TVMDB-065	7880.00	2 Pcs.
8 W	TVMDB-066	10000.00	1 Pcs.
12 W	TVMDB-067	17500.00	1 Pcs.

## Moulded Case Circuit Breaker (MCCBs)

With Fixed Thermal Magnet Release & Adjustable Thermal Setting.



Braking Capacity (ICU) (KA)	Rating (A) 415 V . 50 Hz	Frame	THREE POLE			FOUR POLE		
			C. NO.	Unit Price	PKG.	C. NO.	Unit Price	PKG.
16 KA	100 A.	N 2	EMCCT-008	2150.00	15 Pcs	EMCCF-170	3950.00	15 Pcs.
	125 A.	N 2	EMCCT-017	2690.00	15 Pcs	EMCCF-179	4040.00	15 Pcs.
	160 A.	N 2	EMCCT-026	3140.00	15 Pcs	EMCCF-188	6200.00	15 Pcs.
25 KA	125 A.	N 2	EMCCT-035	3500.00	15 Pcs	EMCCF-197	5300.00	15 Pcs.
	160 A.	N 2	EMCCT-044	4265.00	15 Pcs	EMCCF-206	7550.00	15 Pcs.
	200 A.	N 3	EMCCT-053	6650.00	15 Pcs	EMCCF-215	9350.00	15 Pcs.
	250 A.	N 3	EMCCT-062	7100.00	15 Pcs	EMCCF-224	9980.00	15 Pcs.
35 KA	200 A.	N 3	EMCCT-071	8000.00	15 Pcs	EMCCF-233	10250.00	15 Pcs.
	250 A.	N 3	EMCCT-080	9350.00	15 Pcs	EMCCF-242	12350.00	15 Pcs.
	320 A.	N 4	EMCCT-098	15020.00	15 Pcs	EMCCF-251	17900.00	15 Pcs.
	400 A.	N 4	EMCCT-107	15020.00	15 Pcs	EMCCF-260	17900.00	15 Pcs.
	500 A.	N 5	EMCCT-116	20870.00	15 Pcs	EMCCF-269	22850.00	15 Pcs.
	630 A.	N 5	EMCCT-125	20870.00	15 Pcs	EMCCF-278	22850.00	15 Pcs.
50 KA	320 A.	N 4	EMCCT-134	17000.00	15 Pcs	EMCCF-287	19700.00	15 Pcs.
	400 A.	N 4	EMCCT-143	17900.00	15 Pcs	EMCCF-296	19700.00	15 Pcs.
	500 A.	N 5	EMCCT-152	21500.00	15 Pcs	EMCCF-305	24200.00	15 Pcs.
	630 A.	N 5	EMCCT-161	21500.00	15 Pcs	EMCCF-314	24200.00	15 Pcs.
	800 A.	N 6	EMCCT-170	26450.00	15 Pcs	EMCCF-323	31400.00	15 Pcs.

## MCCB Enclosure's Sheet Steel Suitable For Rating 100 A- 800A. T.P/ F.P

Frame	Rating.	C. NO.	Price	PKG.
N 2	100 / 125 / 160 A	EMCCE- 314	935.00	15 Pcs.
N 3	200 A / 250 A	EMCCE- 323	1520.00	10 Pcs.
N 4	320 A / 400 A	EMCCE- 332	2060.00	2 Pcs.
N 5	500 A / 630 A	EMCCE- 341	2330.00	2 Pcs.
N 6	800 A	EMCCE- 350	3500.00	1 Pcs.

## Industrial Plug & Socket.

### Alluminium Metal Clad

#### Plug

Amp.	Pole	BODY	C. No.	PRICE	PKG.
20 A	2 .P	ABS	SPAB-75	132.00	6/120 Pcs.
20 A	2 .P	AL.	SPSP-76	178.00	6/120 Pcs.
20 A	3 .P	AL.	SPSP-77	246.00	6/120 Pcs.
32 A	3 .P	AL.	SPSP-78	550.00	4/48 Pcs.

HSN Code 85366990

#### Socket

Amp.	Pole	BODY	C. No.	PRICE	PKG.
20 A	2 .P	ABS	SSAB-75	132.00	6/120 Pcs.
20 A	2 .P	AL.	SPSS-76	178.00	6/120 Pcs.
20 A	3 .P	AL.	SPSS-77	246.00	6/120 Pcs.
32 A	3 .P	AL.	SPSS-78	550.00	4/48 Pcs.

HSN Code 85366990

### Weather Proof

#### Plug

Amp.	Pole	C. No.	PRICE	PKG.
20 A	3 .P	SPWP-08	300.00	5/120 Pcs.

HSN Code 85366910

#### Socket

Amp.	Pole	C. No.	PRICE	PKG.
20 A	3 .P	SPWS-017	300.00	5/120 Pcs.

## Industrial Box. Sheet Steel Fitted With Plug , Socket , N. Link & Connection Wires.

HSN Code 85372000

Amp	Plug	MCB SLOT	C.No	D.P	PKG.
20A	2P	S.P	SIB-72	750.00	24 Pcs
20A	2P	D.P	SIB-73	870.00	24 Pcs
20A	3P	F.P	SIB-74	1420.00	15 Pcs
32A	3P	F.P	SIB-75	1900.00	15 Pcs

# PHASE SELECTOR BOARD

## SINGLE PHASE SELECTOR BOARD



Amps	Volts	C. No.	D.Price	PKG.
40 A	415 V	SSPB-001	7200.00	12 Pcs.
63 A	415 V	SSPB-002	1860.00	10 Pcs.

## THREE PHASE SELECTOR BOARD



Amps	Volts	C. No.	D.Price	PKG.
40 A	415V	STPB-003	4890.00	10 Pcs.
63 A	415 V	STPB-004	5100.00	08 Pcs.

## DOUBLE DOOR THREE PHASE SELECTOR DISTRIBUTION BOARD



Amps	Way	C.No.	D.Price	PKG.
40 A	4 Way	STDB-005	8160.00	02 Pcs
63 A	4 Way	STDB-006	8600.00	02 Pcs
40 A	6 Way	STDB-008	8960.00	01 Pcs
63 A	6 Way	STDB-009	9420.00	01 Pcs



## Switch Disconnecter Fuse Unit (S.D.F.U.) T.P.N. 50 Hz. 415 V.

### General Description:

ESCO Heavy Duty SWITCH DISCONNECTOR FUSE UNITS are available from 32 Amp. to 400 Amp. These switches are designed for easy panel mounting in switch boards for power distribution. they can be used for mixed resistive and inductive circuits and capacitor banks in both AC & DC circuits, Specially designed rollar contact system ensure high breaking capacity long contact life and safety under short circuit conditions.

### The salient feature of the switches are:

- Fall proof operating mechanism.
- Double brek mechanism.
- Stationary Fuse links.
- Positive indication of Contact separation.
- Compact size for low panel locations.
- Adjustable handle for different panel locations.
- Padlock, door interlock and defect interlock provided.
- Available in open execution and with enclosure.

### Range & Frame Size:

SIZE	1	32 A,	63 A.
SIZE	2	100 A,	125 A.
SIZE	3	200 A,	250 A, 315 A, 400 A.

### Construction:

The construction of switch is such that it provides maximum protection as well as easy opration. The mechanism of the fuse switch is enclosed in a fully insulated DMC Body which ensures high standards of electrical & mechanical operations. Fuses are stationary in these switches. Inside the body there is a sliding plate which carries rollers while operating the switch rollers itself cleans the fix contacts. There is a double break mechanism which isolator the fuse switch from both incoming & outgoing circuits. Phase barriers are provide for added safety. All the copper contacts & bars are made from highly electrolytic copper and are silver plated for better conductivity.



W/O FUSE

HSN Code 85381020

### Open Excution



Amps.	C. No.	Price.	PKG.
32 A	SSDCS-197	2480.00	04 Pcs.
63 A	SSDCS-198	2800.00	04 Pcs.
125 A	SSDCS-199	5550.00	02 Pcs.
250 A	SSDCS-200	14000.00	02 Pcs.
315 A	SSDCS-201	15900.00	02 Pcs.
400 A	SSDCS-202	17400.00	01 Pcs.

### In S.S. Encloser

Amps.	C. No.	Price.	PKG.
32 A	SSDCS-203	5300.00	04 Pcs.
63 A	SSDCS-204	5700.00	04 Pcs.
125 A	SSDCS-206	8400.00	02 Pcs.
250 A	SSDCS-207	18500.00	02 Pcs.
315 A	SSDCS-208	20400.00	02 Pcs.
400 A	SSDCS-209	21300.00	01 Pcs.

## Switch Fuse Unit (S.F.U)

HSN Code 85361020

Sheet Steel Re-wirable Main Switch with Pre-Fitted Fuse Wire. 50 Hz. 240/415 V

### 2 Pole (D.P)



Amps	Volts	C. No.	Price.	PKG.
16 A	240 V	SAS-026	620.00	20 Pcs
32 A	240 V	SAS-027	1500.00	12 Pcs
63 A	240 V	SAS-028	4160.00	03 Pcs

### 3 Pole with Neutral (T.P.N)

HSN Code 85361020

Amps	Volts	C. No.	Price.	PKG.
16 A	415 V	SAS-029	2120.00	06 Pcs
32 A	415 V	SAS-030	2780.00	04 Pcs
63 A	415 V	SAS-031	5640.00	02 Pcs
100 A	415 V	SAS-032	10250.00	02 Pcs
200 A	415 V	SAS-033	18500.00	01 Pcs

## Fuse Switch Unit (F.S.U)

HSN Code 85361020

Sheet Steel Double Break, 50 Hz. 415 V 3 Pole With Neutral ( T.P.N )

### W/O Fuse Cartridge



Amps	Volts	C. No.	Price.	PKG.
100 A	415 V	SFSU-093	12000.00	02 Pcs
200 A	415 V	SFSU-094	14500.00	01 Pcs
320 A	415 V	SFSU-095	17000.00	01 Pcs
400 A	415 V	SFSU-096	21650.00	01 Pcs
500 A	415 V	SFSU-097	27600.00	01 Pcs
630 A	415 V	SFSU-098	32500.00	01 Pcs
800 A	415 V	SFSU-099	60600.00	01 Pcs
1000 A	415 V	SFSU-100	75000.00	01 Pcs

### With Pre-Fitted Fuse Cartridge

HSN Code 85361020

Amps	Volts	C. No.	Price.	PKG.
100 A	415 V	SFUL-101	13800.00	02 Pcs
200 A	415 V	SFUL-102	16500.00	01 Pcs
320 A	415 V	SFUL-103	19650.00	01 Pcs
400 A	415 V	SFUL-104	26000.00	01 Pcs
500 A	415 V	SFUL-105	36500.00	01 Pcs
630 A	415 V	SFUL-107	43050.00	01 Pcs
800 A	415 V	SFUL-108	73200.00	01 Pcs
1000 A	415 V	SFUL-110	91500.00	01 Pcs



# FUSE UNIT

The Power  
of Power®

## Fuse Unit Porcelain Re-wirable ( Kit-kat )

HSN Code 85361030

**Green (ECO)**



Amps	Volts	Type.	C. No.	D.Price.	PKG.
16 A	240 V	Pilot	SEFU-132	84.00	12/192 Pcs
32 A	240 V	XL	SEFU-133	158.00	6/96 Pcs
16 A	415 V	XL	SEFU-133	158.00	6/96 Pcs
32 A	415 V	XL	SEFU-134	234.00	4/48 Pcs
63 A	415 V	H.C	SEFU-135	350.00	3/36 Pcs
63 A	415 V	XL	SEFU-136	530.00	2/24 Pcs
100 A	415 V	H.C	SEFU-137	710.00	2/18 Pcs
100 A	415 V	XL	SEFU-138	950.00	1/12 Pcs
200 A	415 V	XL	SEFU-139	1950.00	1/09Pcs
#320 A	415 V	XL	SEFU-140	2300.00	1/04 Pcs
#400 A	415 V	XL	SEFU-141	2750.00	1/04 Pcs
#500 A	415 V	XL	SEFU-142	3120.00	1/04 Pcs

# With Extension Strip.

## HEAVY DUTY

HSN Code 85361030



Amps	Volts	Type.	C. No.	D.Price.	PKG.
32 A	415 V	XL	SAF-119	300.00	4/48 Pcs
63 A	415 V	H.C	SAF-120	420.00	3/36 Pcs
63 A	415 V	XL	SAF-121	680.00	2/24 Pcs
100 A	415 V	H.C	SAF-122	860.00	2/18 Pcs
100 A	415 V	XL	SAF-123	1310.00	1/12 Pcs
200 A	415 V	XL	SAF-125	2220.00	1/08Pcs

HSN Code 85361030



Amps	Volts	Type.	C. No.	D. Price.	PKG.
63 A	415 V	XL	SAFL-126	800.00	2/24Pcs
100 A	415 V	XL	SAFL-127	1540.00	1/12Pcs
200 A	415 V	XL	SAFL-128	2680.00	1/08Pcs
320 A	415 V	XL	SAFL-129	3000.00	1/04Pcs
400 A	415 V	XL	SAFL-130	3700.00	1/04Pcs
500 A	415 V	XL	SAFL-131	4100.00	1/04Pcs
500 A	415 V	XXLH	SAFL-132	5700.00	1/04Pcs

## H.R.C Round Fuse Cartridge.

HSN Code 85361040

Bolted Connection Type 50 Hz. 415 V 80 Ka



Amps	Type	C. No.	Price.	PKG
6,10,16,20,25,32 A	ESTIA-32	SRFL-109	100.00	10/300 Pcs.
63 A	ESTIS-63	SRFL-110	270.00	10/300 Pcs.
100 A	ESTCP-100	SRFL-111	300.00	6/180 Pcs.
200 A	ESTF-200	SRFL-112	440.00	03/90 Pcs.
320 A	ESTKF-315	SRFL-113	660.00	1/30 Pcs.
400 A	ESTSMS-400	SRFL-114	1040.00	1/30 Pcs.
500 A	ESTTM-500	SRFL-116	2400.00	1/24 Pcs.
630 A	ESTTM-630	SRFL-117	3000.00	1/24 Pcs.
800 A	ESTSL-800	SRFL-118	3500.00	1/12 Pcs.
1000 A	ESTSL-1000	SRFL-119	4400.00	1/06 Pcs.

## H.R.C Square Fuse Cartridge.

HSN Code 85361040

Din Type With Blade Contact 50 Hz. 415 V 80 Ka



Amps	PRICE ( as per size )			
	(00)	(01)	(02)	(03)
63 A	300.00	-----	-----	-----
80 A	300.00	-----	-----	-----
100 A	300.00	-----	-----	-----
125 A	300.00	620.00	-----	-----
160 A	-----	620.00	-----	-----
200 A	-----	620.00	840.00	-----
250 A	-----	620.00	840.00	-----
315 A	-----	620.00	840.00	-----
400 A	-----	-----	840.00	1250.00
500 A	-----	-----	-----	1250.00
630 A	-----	-----	-----	1250.00

## DMC H.R.C Fuse Base Open Type

HSN Code 853890

Din Type With Copper Blade Contact 50 Hz. 415 V 80 Ka



Amps	C. No	Price	PKG
160 A	SHFB-08	300.00	10/100 Pcs.
250 A	SHFB-17	1040.00	6/60 Pcs.
400 A	SHFB-26	1250.00	3/30 Pcs.
630 A	SHFB-35	2200.00	1/15 Pcs.

# Change Over Switches

## On Load

### Four Pole, 50 Hz., 415 V.

Overall Dimensions of On Load Changeover Switches (All Dimensions are in M.M.)

AMPS	FRAME SIZE	TOTAL	TOTAL	HEIGHT	TOTAL	FEETHOLE				TERMINAL			
		LENGTH	BREATH	HEIGHT	HEIGHT	D	F	G	H	WIDTH	THICKNESS	N	M
		A	B	C	WITHHANDLE	C-1				J	K		
125	1	225	155	165	300	170	145	95	115	25	3	50	120
160	1	225	155	165	300	170	145	95	115	25	3.5	50	120
200	1	225	155	165	300	170	145	95	115	25	4	50	120
250	2	280	200	180	315	230	210	112	130	32	4.5	60	140
320	2	280	200	180	315	230	210	112	130	32	4.8	60	140
400	3	360	250	255	390	290	260	175	200	40	5	85	195
630	3	360	250	255	390	290	260	175	200	55	5	85	195

Overall Dimensions of On Load Changeover Switches In Sheet Steel Enclosure (All Dimensions are in M.M.)

AMP	Frame Size	A	B	C	D	E	FG
125/160/200	1	425	385	350	230	282	4260
250/320	2	520	480	448	345	400	4275
400/630	3	595	555	510	395	475	4340

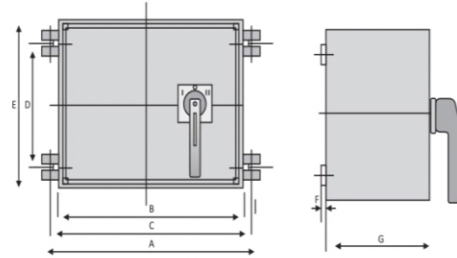
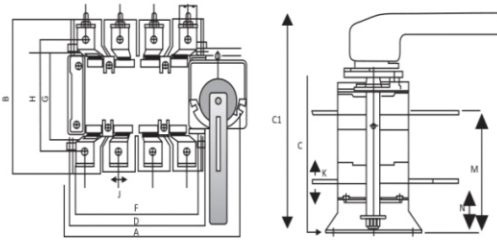

#### DESCRIPTION :

ESCO heavy duty ON LOAD CHANGEOVER SWITCHES are designed for easy panel mounting in switchboards for application in low voltage distribution circuits and motor circuits. They are used at places where continuity of supply is necessary for switching to an alternative source of supply from main supply & vice-versa. ON LOAD CHANGEOVER SWITCHES are available in open execution as well as in sheet steel enclosure.

#### CONSTRUCTION :

ESCO ON LOAD CHANGEOVER SWITCHES are made of two load switch disconnectors which are coupled together and are mechanically interlocked with a common outgoing. The mechanism of ON LOAD CHANGEOVER SWITCH is enclosed in a fully insulated DMC Body which ensures high standards of

electrical & mechanical properties. THE CONTACT mechanism of ON LOAD CHANGEOVER SWITCH is knife blade type. Inside the body a moving plate carries four blades per pole. Using on position contact is made with the main contact. Copper used is of E.T.P. Grade & is silver plated for maximum conductivity.

#### TECHNICAL DATA :

Rate operational voltage (Ue)	: 415 V.A.C.
Utilization category	: AC-23A
No. of POLES	: 4 Poles (With switched neutral)
Rated insulation voltage (Ui)	: 1000V
Temp with stand Range (ambient)	: -5 to 50°C
Voltage (Uimp)	: 10 kv
Dielectric strength at 50 Hz	: 5000 KV

HSN Code 85365010



### Open Execution 415 V.

Amps.	C. No.	Price.	PKG.
63 A	SOLCO-182	6000.00	04 Pcs.
125 A	SOLCO-183	11400.00	04 Pcs.
200 A	SOLCO-184	13300.00	02 Pcs.
250 A	SOLCO-185	21000.00	02 Pcs.
320 A	SOLCO-186	22800.00	02 Pcs.
400 A	SOLCO-188	34500.00	01 Pcs.
630 A	SOLCO-189	46000.00	01 Pcs.

### In Sheet Steel Encloser

Amps.	C. No.	Price.	PKG.
63 A	SOLCO-190	8600.00	02 Pcs.
125 A	SOLCO-191	15600.00	02 Pcs.
200 A	SOLCO-192	17400.00	01 Pcs.
250 A	SOLCO-193	28400.00	01 Pcs.
320 A	SOLCO-194	30000.00	01 Pcs.
400 A	SOLCO-195	45500.00	01 Pcs.
630 A	SOLCO-197	54500.00	01 Pcs.

**Automatic** Sheet Steel , 50 Hz. 240/415 V  
With Gen. Set Switch Off Function

HSN Code 85365010



**2 Pole ( D.P )**

Amps	C. No.	Price	PKG.
25A	SACI-132	1320.00	24 Pcs.
32A	SACA-134	2060.00	12 Pcs.
63A	SACA-135	6540.00	06 Pcs.

**4 Pole ( F.P )**

Amps	C. No.	Price	PKG.
32 A	SACA-136	5450.00	06 Pcs.
63A	SACDG-017	14900.00	04 Pcs.
100A	SACDG-026	25100.00	03Pcs.
200 A	SACDG-035	48900.00	02Pcs.

**Off Load** Sheet Steel , 50 Hz. 240/415 V

**Porcelain Base**

HSN Code 85365010



**2 Pole ( D.P )**

Amps	Volts	C. No.	Price	PKG.
16 A	240 V	SAC-138	1070.00	20 Pcs
32 A	415 V	SAC-139	1540.00	12 Pcs
63 A	415 V	SAC-140	4330.00	03 Pcs

**3 Pole ( T.P )**

Amps	Volts	C. No.	Price	PKG.
16 A	415 V	SAC-141	2400.00	20Pcs.
32 A	415 V	SAC-143	2550.00	12Pcs.
63 A	415 V	SAC-144	6200.00	04Pcs.

HSN Code 85365010

**4 Pole ( F.P )**

Amps	Volts	C. No.	Price	PKG.
16 A	415 V	SAC-145	2460.00	06 Pcs.
32 A	415 V	SAC-146	2620.00	04Pcs.
63 A	415 V	SAC-147	6530.00	02Pcs.
100 A	415 V	SAC-148	11400.00	02Pcs.
200 A	415 V	SAC-149	22200.00	01Pcs.

HSN Code 85365010

**Fiber Base - Knife type**

**4 Pole ( F.P )**



Amps	Volts	POLE	C. No.	Price	PKG
63 A	415 V	D.P	SACK-150	4740.00	3 Pcs
63 A	415 V	F.P	SACK-152	8400.00	2 Pcs
100 A	415 V	F.P	SACK-153	9430.00	2 Pcs
200 A	415 V	F.P	SACK-154	23900.00	1 Pcs
320 A	415 V	F.P	SACK-155	26000.00	1 Pcs
400 A	415 V	F.P	SACK-156	45300.00	1 Pcs
500 A	415 V	F.P	SACK-157	49500.00	1 Pcs
#630 A	415 V	F.P	SACK-158	65300.00	1 Pcs
#800 A	415 V	F.P	SACK-159	103800.00	1 Pcs
#1000 A	415 V	F.P	SACK-161	166800.00	1 Pcs
#1200 A	415 V	F.P	SACK-162	192000.00	1 Pcs
#1500 A	415 V	F.P	SACK-163	288000.00	1 Pcs

# Double Handle

## L. T. Control Switch (Reverse & Forward Switch )



### Triple Pole, 50 Hz. 415 V

Amps	C. No.	Price	PKG.
16 A	SLT-131	510.00	25 Pcs.
25/32 A	SLT-132	910.00	18 Pcs.

## Spares

## Re-Wireable Switch Fuse Units

### PRICE

AMP/VOLTS	NEUTRAL LINK	ENDSHIELD BLOCK	ACTION BAR COMPLETE	BASE Complete With Metal
16 - 240	-----	-----	107.00	170.00
32 - 240	-----	-----	179.00	269.00
16 - 415	80.00	107.00	215.00	-----
32 - 415	98.00	179.00	440.00	-----
63 - 415	170.00	287.00	665.00	-----
100 - 415	305.00	530.00	1295.00	-----
200 - 415	620.00	1790.00	2240.00	-----



## Double Break Combination Fuse Switch Units

### PRICE

AMP/VOLTS	Base Plate Complete With Contacts & Bakelite Enclosure ( Fixed Contacts )	Action Bar Complete with 3 bakelite arms having 2 copper blades ( Moving Contacts )
63 - 415	1475.00	2060.00
100 - 415	2285.00	2600.00
200 - 415	2780.00	3500.00
320 - 415	3680.00	4850.00

Note:- Price for higher range only against enquiry.

## Off Load Change Over Switches

### Enshield Set with Metal Parts

### Action Bar with Metal Parts Set

AMP/VOLTS	PRICE	Action Bar with Metal Parts Set		
		D.P	D.P	D.P
16 - 240	-----	233.00	-----	-----
16 - 415	179.00	-----	413.00	485.00
32 - 415	215.00	566.00	575.00	755.00
63 - 415	413.00	1070.00	1430.00	1880.00
100 - 415	575.00	-----	-----	3275.00
200 - 415	1925.00	-----	-----	5930.00

# BUS BAR CHAMBERS

PURE ELECTROLYTIC COPPER CONDUCTORS, SHEET STEEL, 50Hz. 240/415 V.

HSN CODE 85369030

## MULTI LEVEL (M.L)



**Green (ECO)**



Amps	Volts	Pole	C.No.	Size(mm)			D.Price	PKG
				L	B	H		
32A	240V	2P	SABE-161	230	120	68	990.00	12Pcs.
63 A	240 V	2P	SABE-170	260	160	115	1670.00	08Pcs.
32 A	415V	4P	SABE-172	230	178	68	1490.00	08 Pcs.
63A	415V	4P	SEBM-163	260	216	115	2350.00	08Pcs.
100A	415V	4P	SEBM-190	325	230	128	4110.00	05Pcs.
200A	415V	4P	SEBM-230	433	356	160	6990.00	03Pcs.

## HEAVY DUTY (M.L H.D)

FOUR POLE



Amps	Volts	C.No.	Size(mm)			D.Price	PKG.
			L	B	H		
32A	415V	SBML-174	230	191	90	1900.00	08Pcs.
63A	415V	SBML-176	312	216	115	3020.00	06Pcs.
100A	415V	SBML-177	370	242	143	5100.00	04Pcs.
200A	415V	SBML-178	485	356	158	9100.00	02Pcs.
320A	415V	SBML-179	485	356	158	10900.00	02Pcs.
400A	415V	SBML-180	560	356	178	14000.00	01Pcs.
500A	415V	SBML-181	560	356	178	17000.00	01Pcs.
630A	415V	SBML-182	585	407	260	26600.00	01Pcs.
800A	415V	SBML-183	585	407	260	40100.00	01Pcs.

## REGULAR

FOUR POLE



Amp	Volts	C.No.	SIZE(mm)			D.PRICE	PKG.
			L	B	H		
320A	415V	SABR-165	621	415	153	13100.00	01Pcs.
400A	415V	SABR-166	621	415	153	15000.00	01Pcs.
500A	415V	SABR-167	621	415	153	21500.00	01Pcs.
630A	415V	SABR-168	662	458	153	29400.00	01Pcs.
800A	415V	SABR-170	662	458	153	44400.00	01Pcs.
1000A	415V	SABR-171	738	494	163	53000.00	01Pcs.
1250A	415 V	SABR-172	915	840	280	68000.00	01Pcs.
1500A	415 V	SABR-173	1040	915	305	84000.00	01Pcs.
2000A	415 V	SABR-174	1170	990	305	117500.00	01Pcs.

## BUS BAR CHAMBERS

ELECTROLYTIC COPPER CONDUCTERS, SHEET STEEL, 50Hz. 240/415 V.  
HSN CODE 85369030

### H.R.C. Fuse Cartridge Compatible ( F.P)



Amps	Volts	C. No.	D.Price	PKG.
63 A	415 V	SABH-176	4260.00	03 Pcs.
100 A	415 V	SABH-177	6900.00	02 Pcs.
200 A	415 V	SABH-179	13500.00	01 Pcs.
320 A	415 V	SABH-180	14400.00	01 Pcs.
400 A	415 V	SABH-181	15900.00	01 Pcs.
500 A	415 V	SABH-182	22200.00	01 Pcs.

### Isolator Compatible (F.P)



Amps	Volts	C. No.	D.Price	PKG.
63 A	415 V	SABI-183	3200.00	03 Pcs.
100 A	415 V	SABI-184	5160.00	02 Pcs.

### Porcelain Fuse Unit (F.P)



Amps	Volts	C. No.	D.Price	PKG.
63 A	415 V	SBFU-008	5590.00	03 Pcs.
100 A	415 V	SBFU-017	9100.00	02 Pcs.
200 A	415 V	SBFU-026	17000.00	01 Pcs.
320 A	415 V	SBFU-035	18500.00	01 Pcs.
400 A	415 V	SBFU-044	20600.00	01 Pcs.
500 A	415 V	SBFU-053	23300.00	01 Pcs.



## TERMS & CONDITIONS

1. This Price List Supersedes all our previous Price List.
2. Price are subject to change without prior Notice.
3. Disputes if any, are subject to Delhi Jurisdiction only.
4. All Prices are ex-godown & all the freight charges has to bear by the dealers.
5. Claims if any, has to be settled by purchaser direct with the carriers. The Company will not be responsible for any kind of shortage, damage or loss caused in the transit.
6. Company reserves the rights to issue amendment, which may arise due to any errors in the price list.
7. Company reserve the rights to excute the order full or in part.
8. All Prices are in Indian Rupees.
9. GST, All the other Taxes & Cess such as Central, State or Local which if levied shall be charged extra at actual.

- C** CORPORATE OFFICE
- UNITS
- ★** DEALERS NETWORK



[s-escoelectricals.com](http://s-escoelectricals.com)



[Info@s-escoelectricals.com](mailto:Info@s-escoelectricals.com)



[escoswitchgears@gmail.com](mailto:escoswitchgears@gmail.com)

## ELECTRICAL SALES CORPORATION

ADD. D-35, Sector 2, DSIIDC  
Bawana Ind. Area, Delhi-110039

